

WH64 Mono & WH64 Dual DECT Wireless Headset



Quick Start Guide V1.1



Please update the headset to the latest version via Yealink USB Connect (PC) before using.

1 Package List



WHD642 Headset

or



WHM641 Headset



WHB640 Base

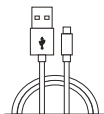

USB 2.0 Cable
(USB-A to USB-C)

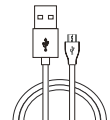

USB 2.0 Cable
(Micro USB to USB-A)

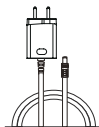

Power Adapter

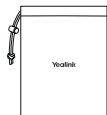

Drawstring Bag



Quick Start Guide

Note: We recommend that you use the included accessories, as other accessories may have compatibility issues that prevent them from working properly.

2 Overview

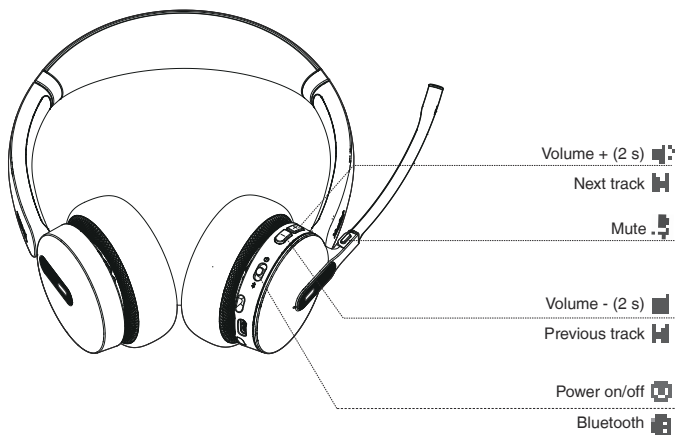
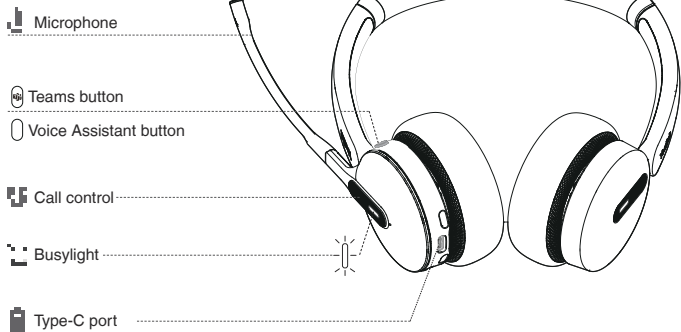

3 Pairing and Connecting Device

• Headset Bluetooth Mode

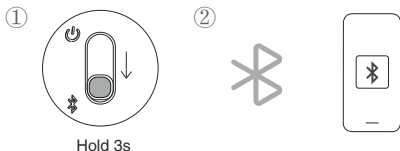

• Dect Mode

Using the diagram, connect the base to your PC, power outlet and desk phone's headset port, if available.

For the initial use, the headset is successfully paired with the base when you dock it in the base.

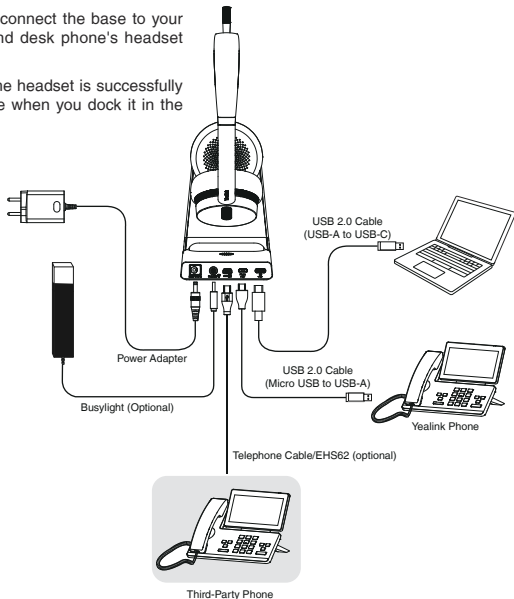

Note:

For more information about the Telephone Cable & EHS62, please refer to the user guide.

4 Charging

USB Charging



Charging Stand

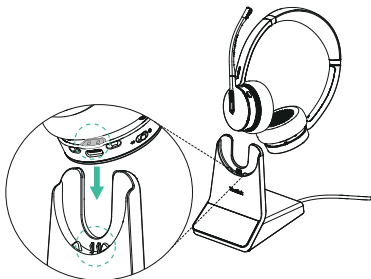

Note: We recommend to fully charge the headset when using it for the first time.

LED Indicator Status

Charging

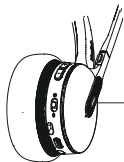

Breathing green LED indicator

Fully Charged

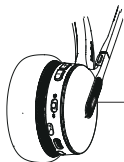







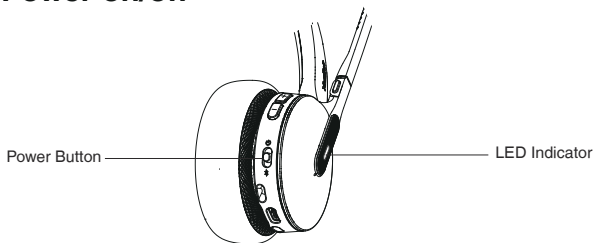



Solid green LED indicator

Note: It takes 1.5 hours to fully charge the headset.

5 Power on/off



Power Button	LED Indicator	Prompt Sound
  →   Power on	Solid green for 2 seconds	 "power on, battery low/medium/high"
  →   Power off	Solid red for 2 seconds	 "power off"

6 Call Control

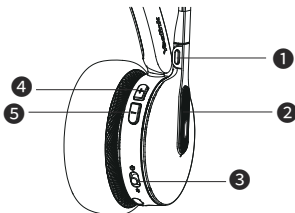

Item	Headset Action
Mute/unmute call	Press 1 .
Volume up/down	Press 4 / 5 .
Answer call	Press 2 .
End call	Press 2 .
Reject call	Double-press 2 .
Hold/unhold call	<ul style="list-style-type: none">- Press 2 for 2 sec to hold call.- Press 2 for 2 sec or press once to unhold call.
Redial	Double-press 2 .

7 Fit Headset

Support dual-sided wearing.

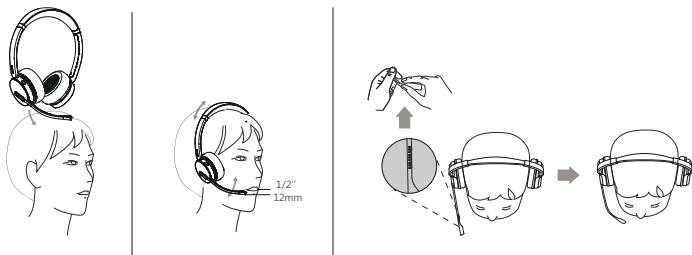

8 Replace Ear Cushions

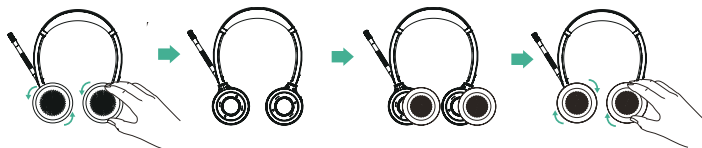

9 Software Management

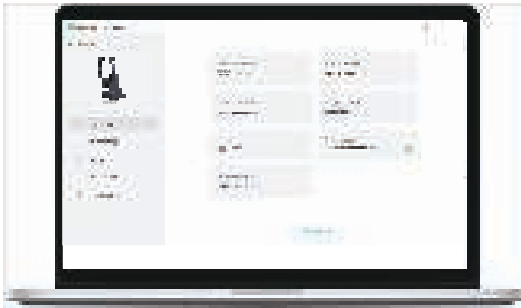

Download Yealink USB Connect from the Yealink website <https://www.yealink.com/product/yuc>.



© 2000 Blackwell Science Ltd, *Journal of Internal Medicine* 247: 395–401

TEL: 011-2610 1234 FAX: 011-2610 5678

|| * ||

About Yealink

Yealink (Stock Code: 300628) is a global-leading provider of Unified Communication & Collaboration Solutions specialized in video conferencing, voice communications, and collaboration, dedicated to helping every person and organization embrace the power of "Easy Collaboration, High Productivity".

With best-in-class quality, innovative technology, and user-friendly experiences, Yealink is one of the best providers in more than 140 countries and regions, ranks No.1 in the global market share of IP Phone, and is the Top 5 leader in the video conferencing market (Frost & Sullivan, 2021).

Copyright

Copyright © 2024 YEALINK(XIAMEN) NETWORK TECHNOLOGY CO., LTD.

All rights reserved. No parts of this publication may be reproduced or transmitted in any form or by any means, electronic or mechanical, photocopying, recording, or otherwise, for any purpose, without the express written permission of Yealink(Xiamen) Network Technology CO., LTD.



Please scan the QR code to see the User Guide



430104002670

YEALINK(XIAMEN) NETWORK TECHNOLOGY CO.,LTD.
Web: www.yealink.com
Copyright©2024YEALINK(XIAMEN) NETWORK
TECHNOLOGY CO.,LTD. All rights reserved.