

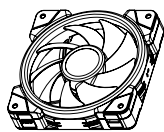

### Parts List

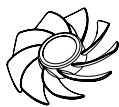

A x 3



B x 3

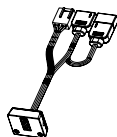

C x 3



D x 12



E x 12



F x 1

### Installation Guide

#### 1 Choose your fan blade type

**Standard Fan Blade** (Pre installed on the fan A)

Airflow Direction:  
**Air Exhaust**

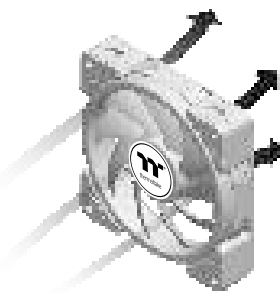
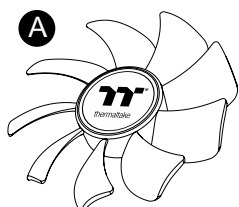

**Reverse Fan Blade**

Airflow Direction:  
**Air Intake**

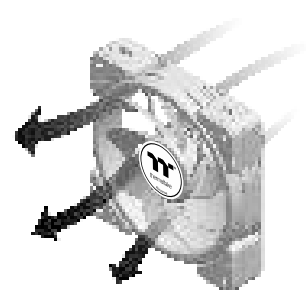
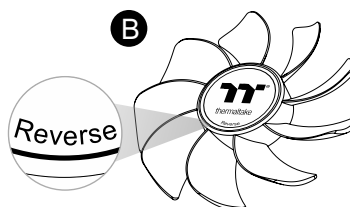

#### 2 Replace fan blades

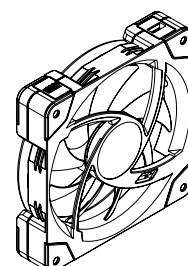
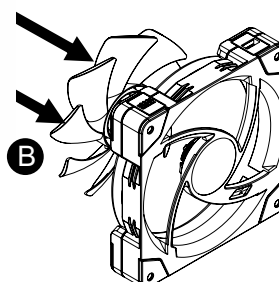
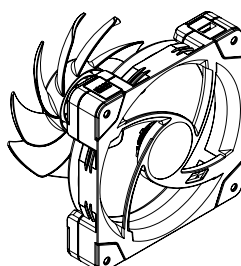
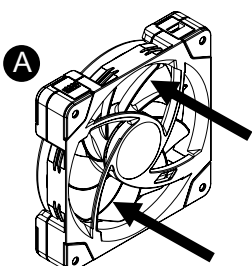

#### 3

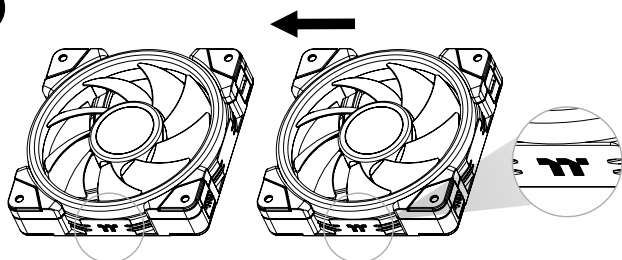

#### 4

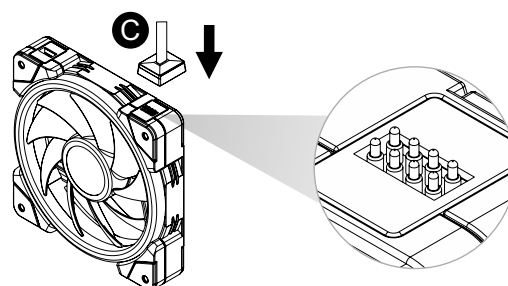

#### 5

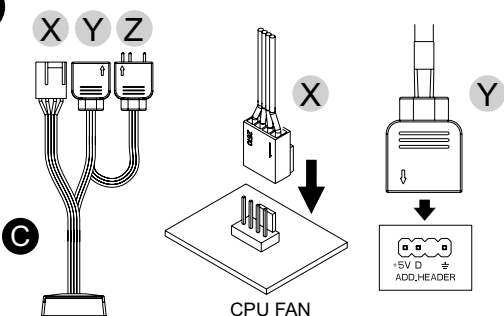

#### CAUTION

Please power off the PC and check the Positive and Negative ends on the connector before connecting the cable to motherboard. Connecting the wrong end can damage the fans.

### Oil Setup Guide

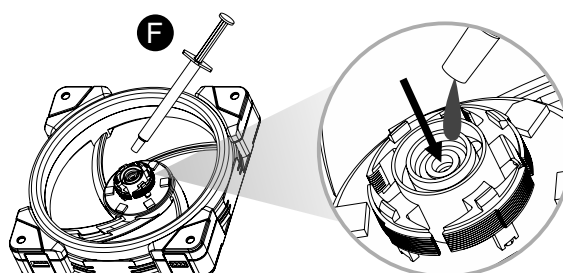

After replacing the fan blades several times, readd the oil into the bearing (about 0.1ml)